

Drawing lines-groups as one item/lines as single items.

Left clicking makes line 4.

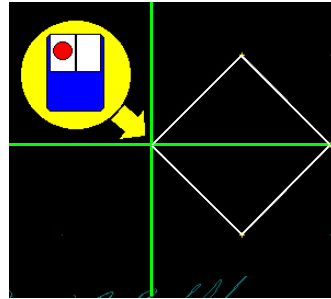

Right click to end line selection. You have created four connected lines which are seen by the program to be one item.

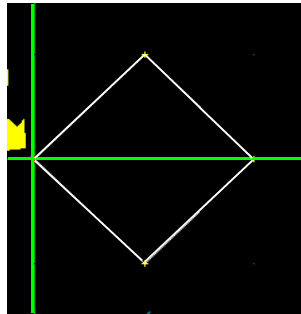

In the future, selecting on any of the four lines will bring all four lines of the object into selection.

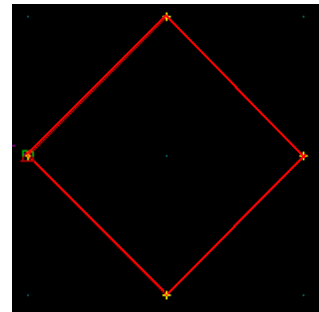

The four lines shown here were each individually drawn by selecting the line command to draw each one. When drawing in Super-Cam, it helps to remember that your machine is going

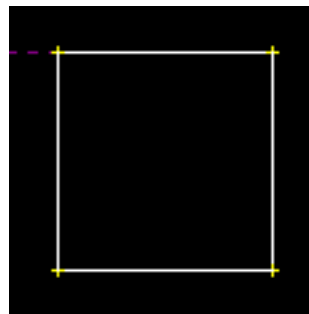

to cut items in the series you drew them in. You can change the order in which items are cut at any time you wish with the “chngorder” command.

The square made from four separate line entities is easily edited. In this example, the erase command is active. The line

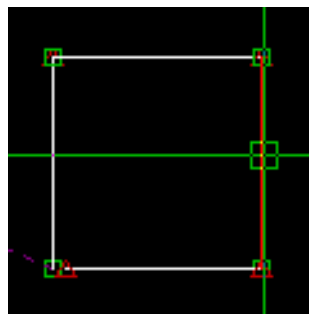

Completing the erase command removes the single line.

